

- ① FONDO
- ② FIANCO SINISTRO
- ③ FIANCO DESTRO
- ④ SCHIENA
- ⑤ COPERCHIO
- ⑥ ANTA

ASSEMBLAGGIO

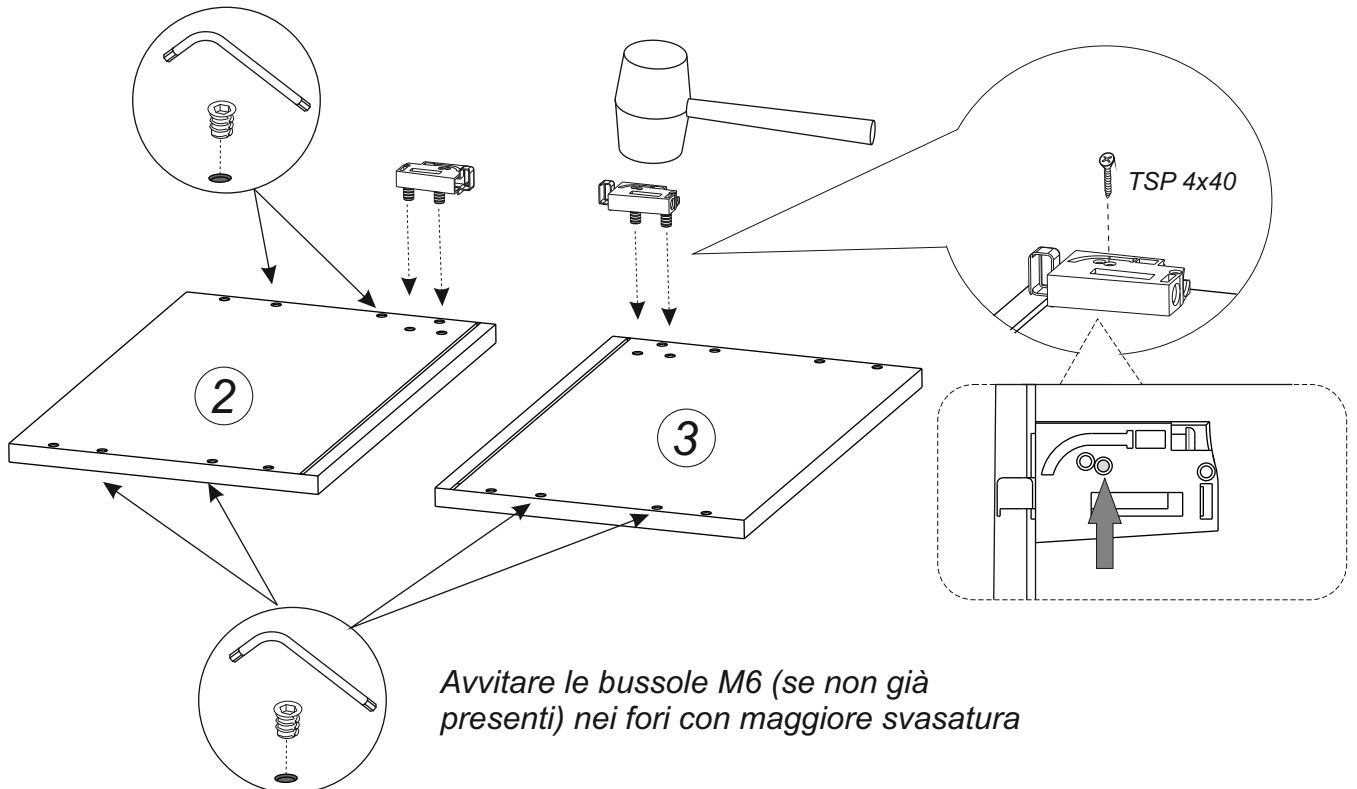

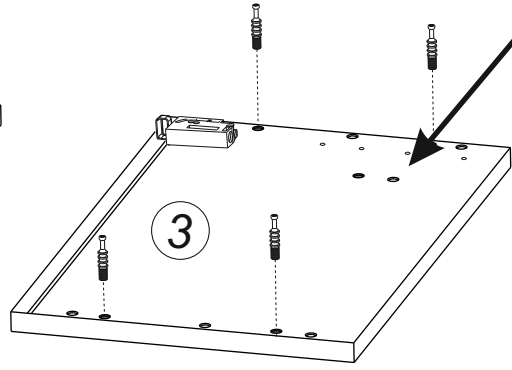
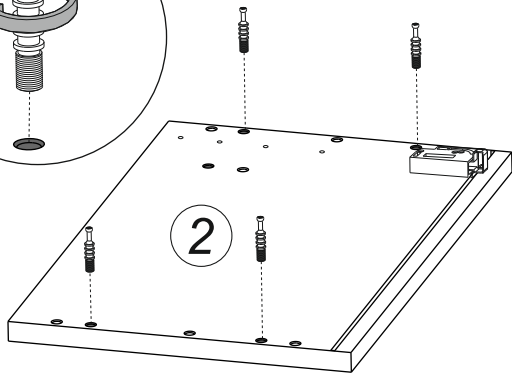
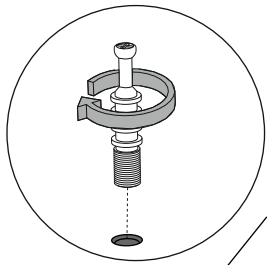

***** Per apertura tip-on su sistema HK TOP inserire pistoncino

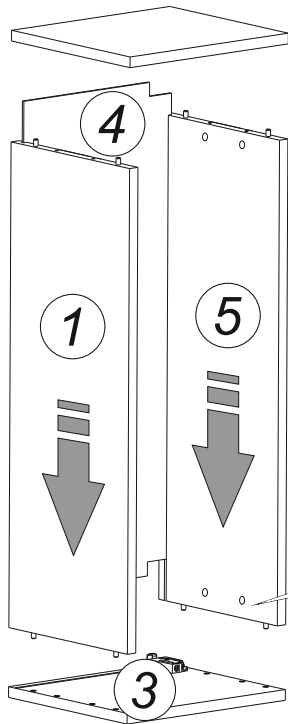
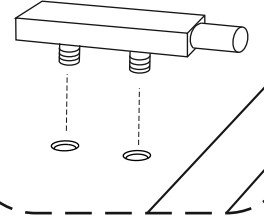

Lato fianco

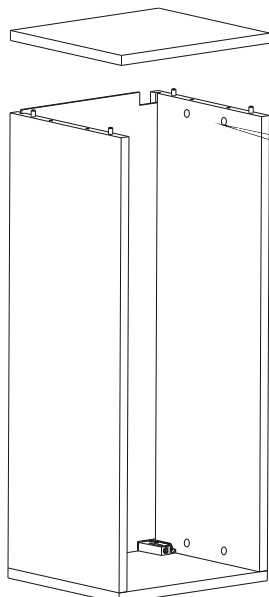
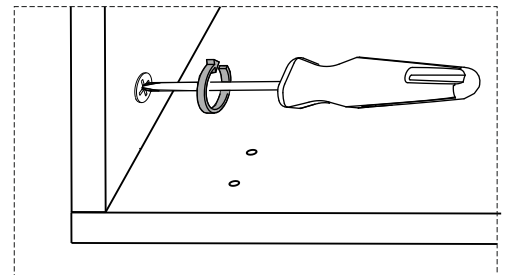
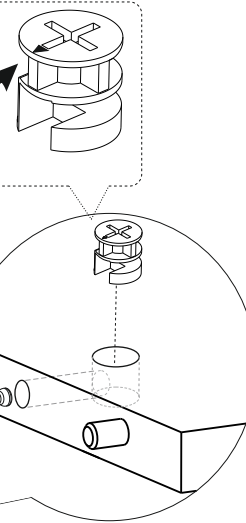

Lato fianco

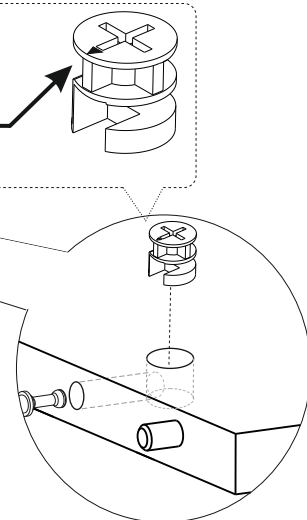

****** Per pensile con $L > 900\text{mm}$ vedere fondo pagina 6

SISTEMA HK S

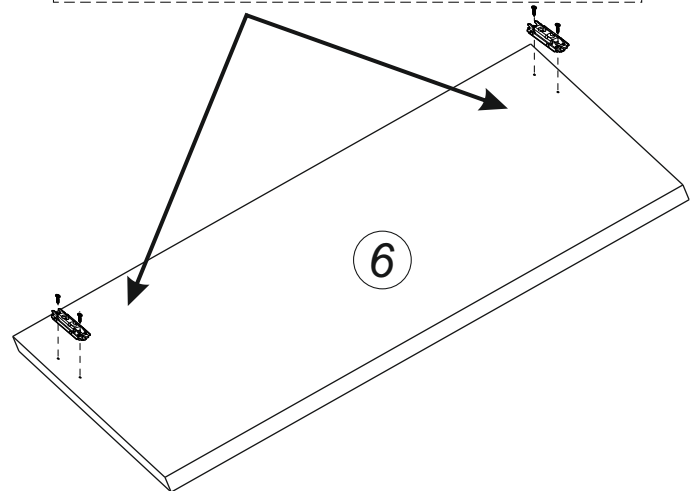
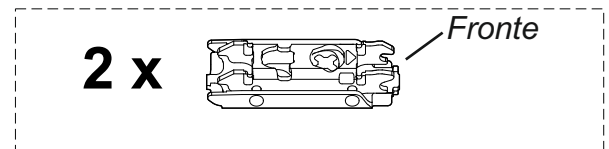
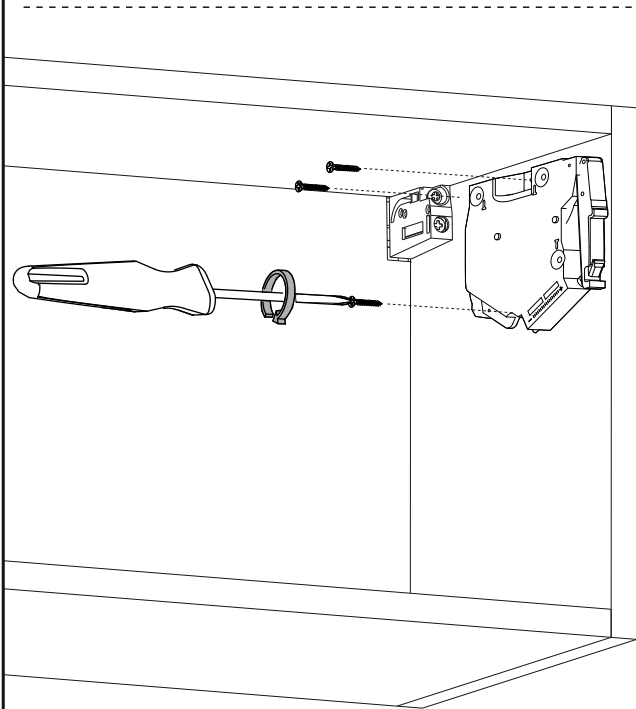
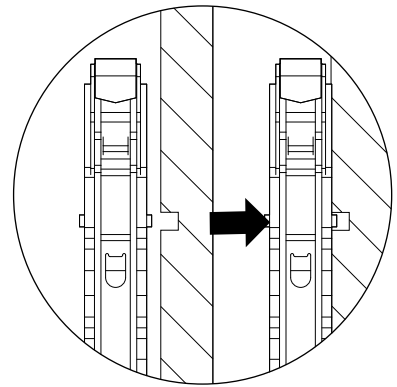
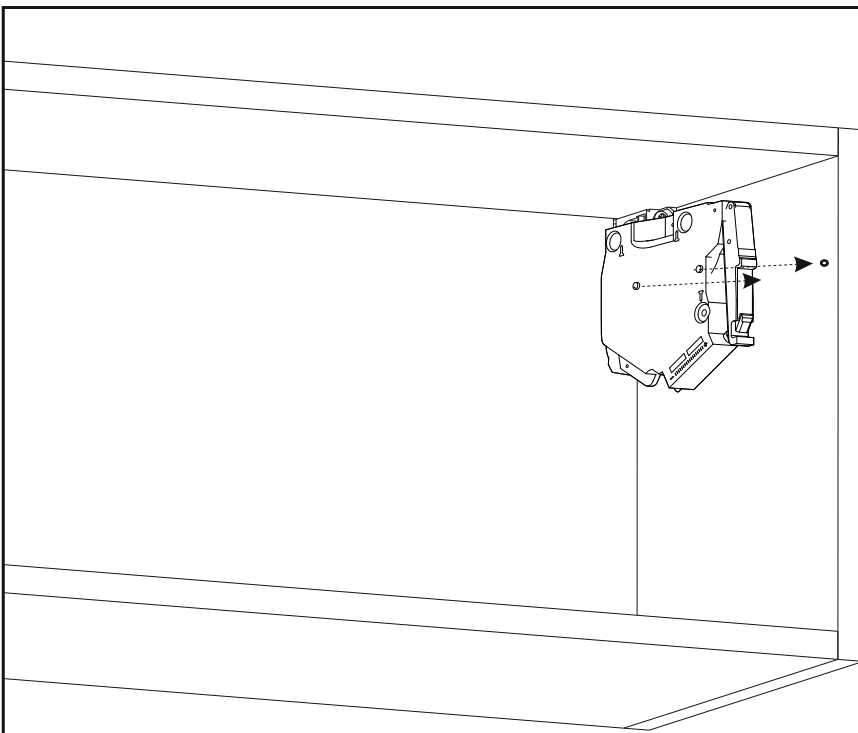

Pericolo di lesioni a causa del possibile scatto della leva verso l'alto !

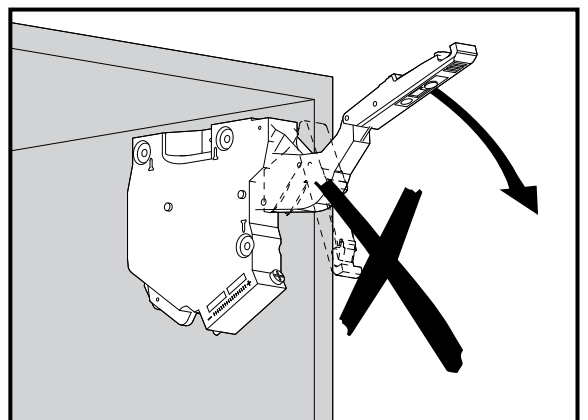

Non spingere la leva verso il basso dopo averla sollevata

SISTEMA HK S

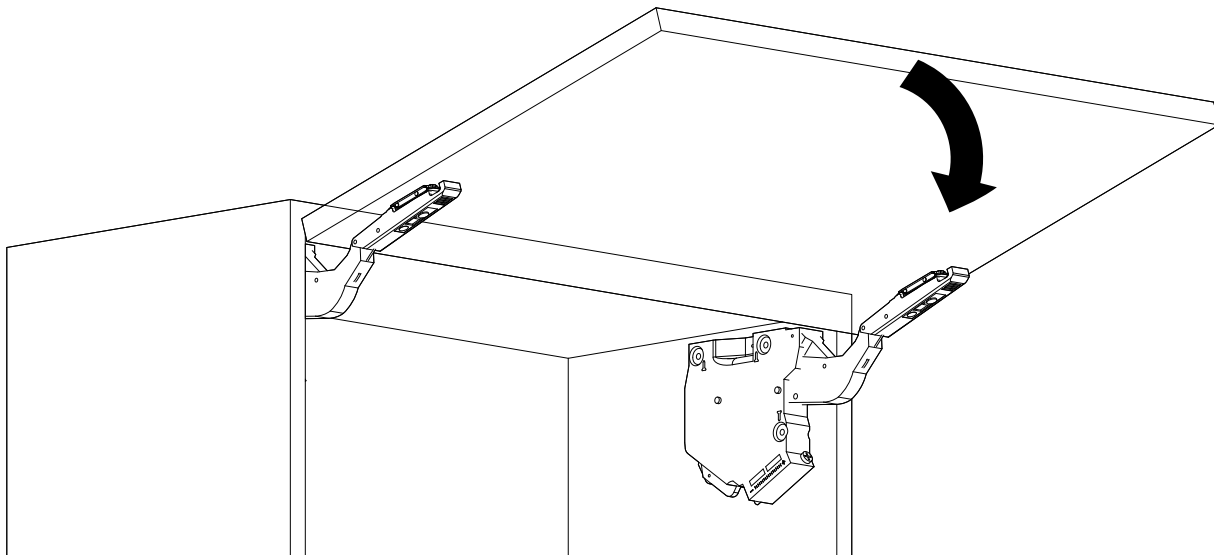
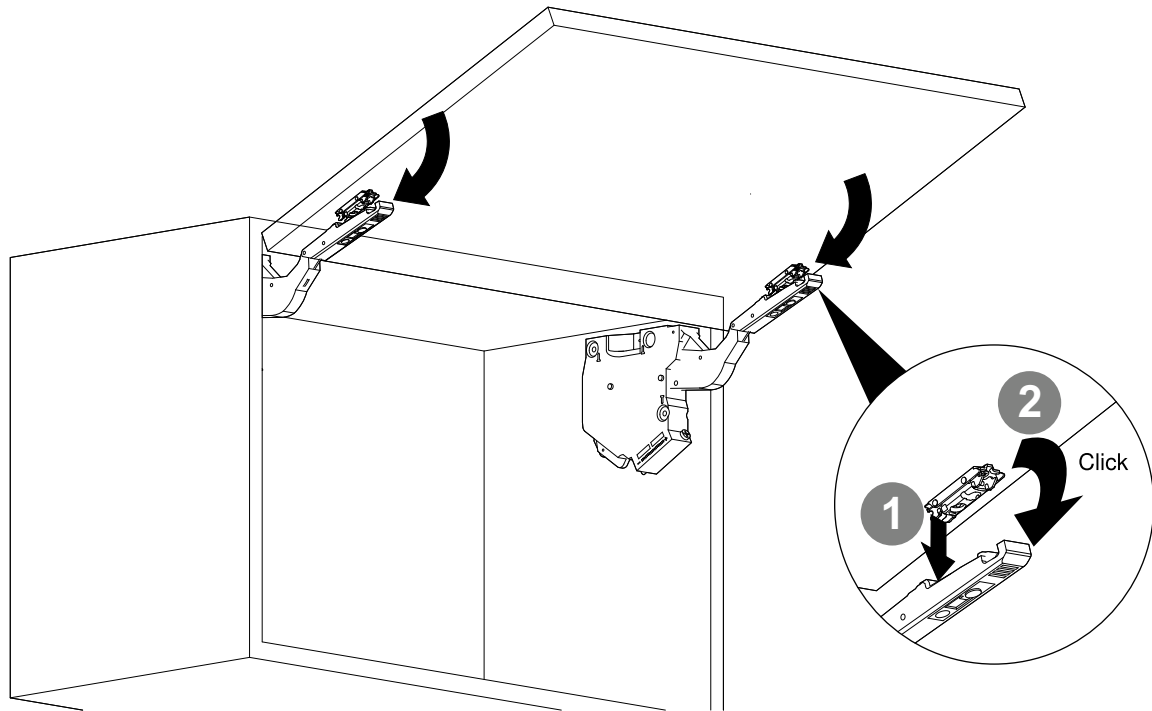
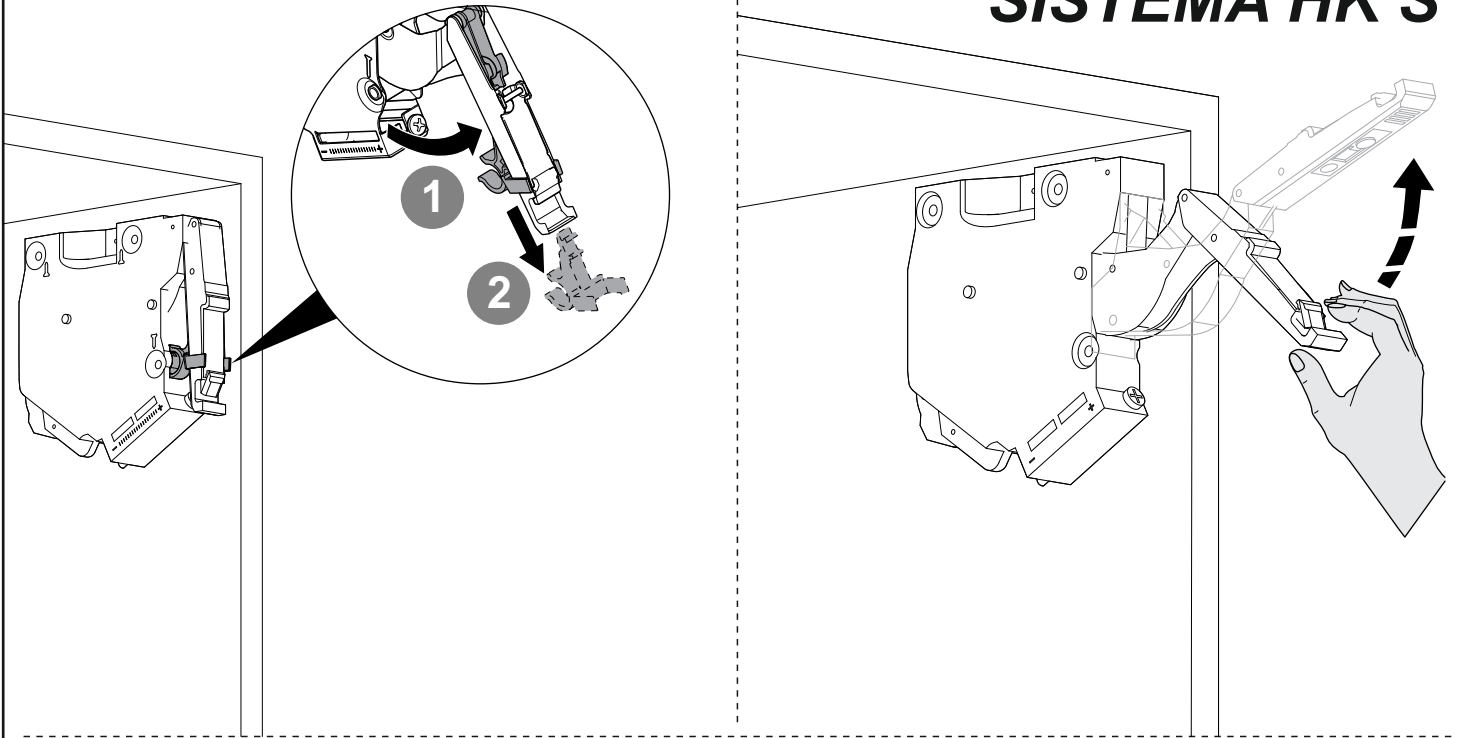

SISTEMA HK S

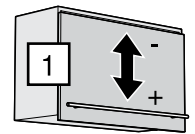
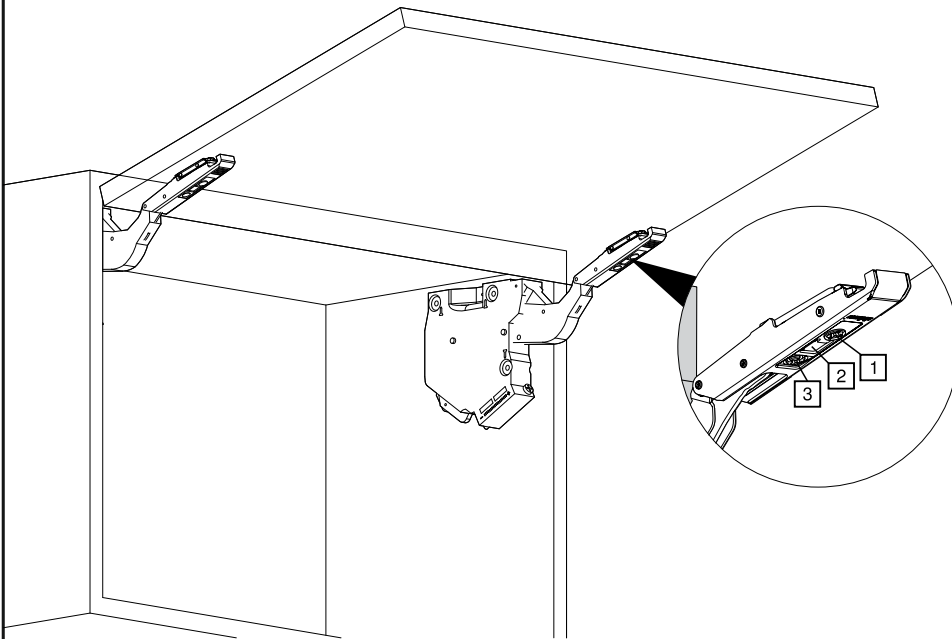
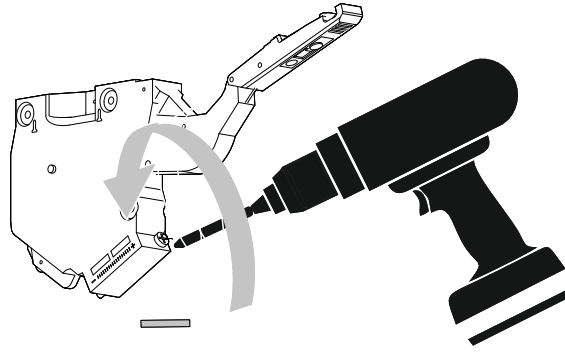
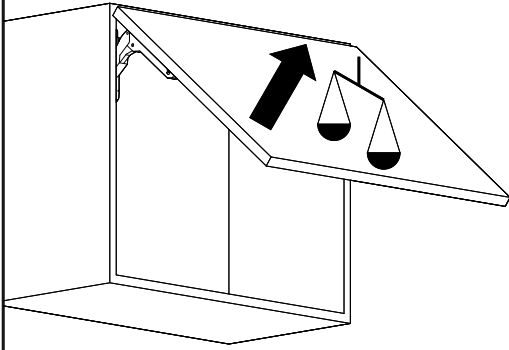
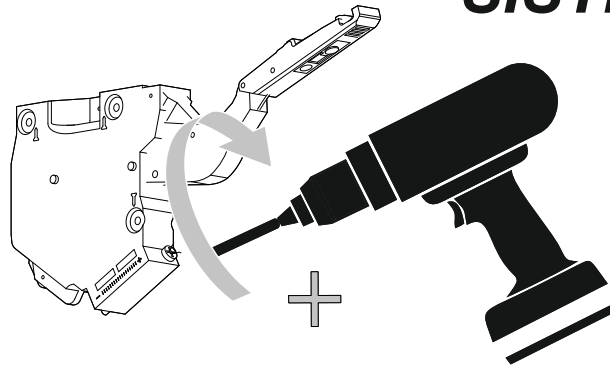
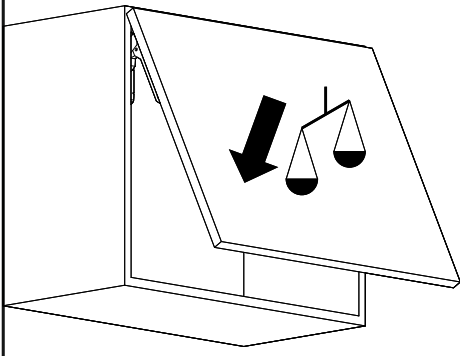

± 2

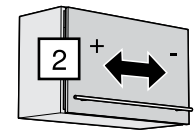

± 2

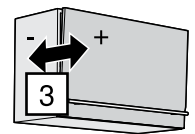

± 2

ASSEMBLAGGIO LIMITATORI DI APERTURA

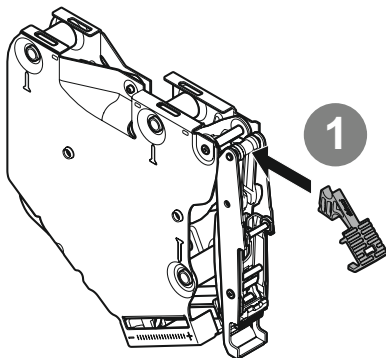

1

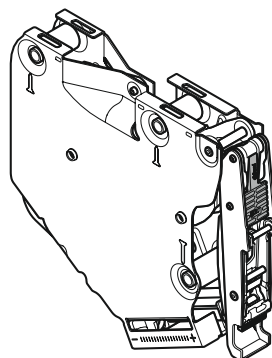

2

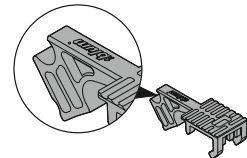

75°

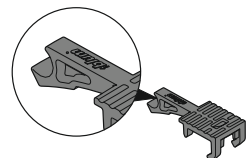

100°

SISTEMA HK TOP

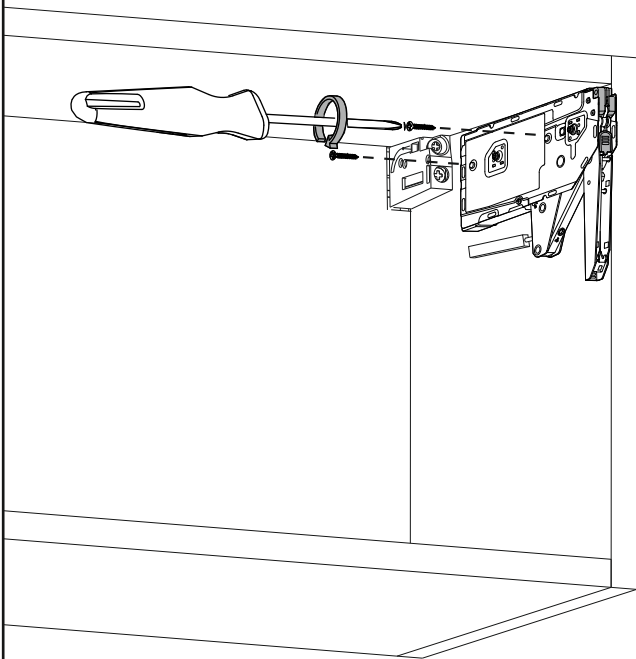
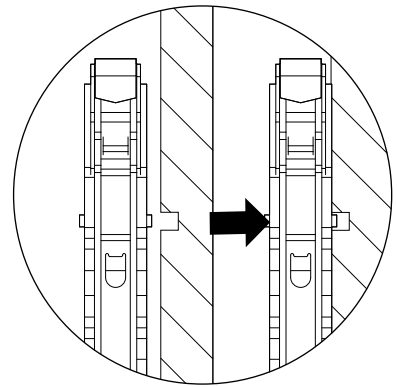
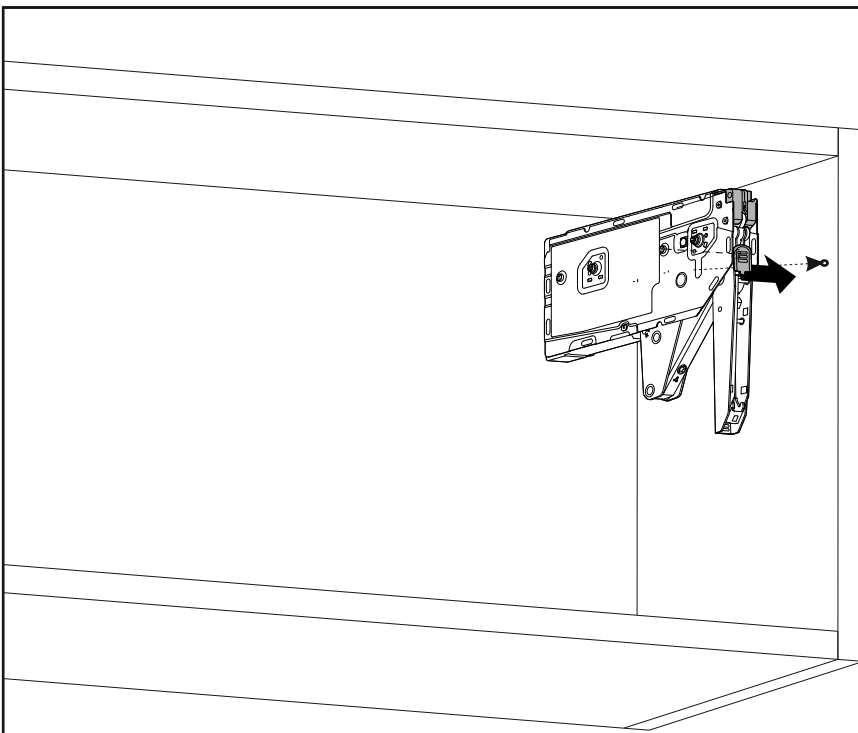

2 x

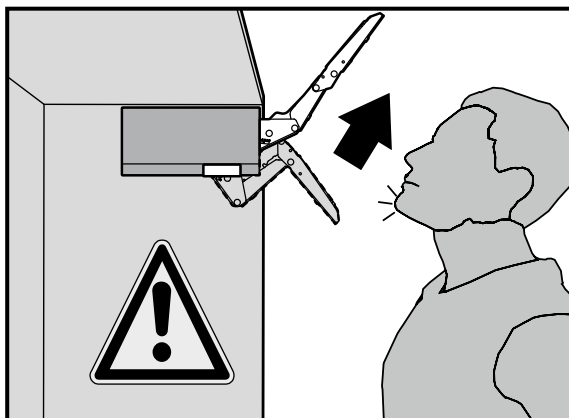
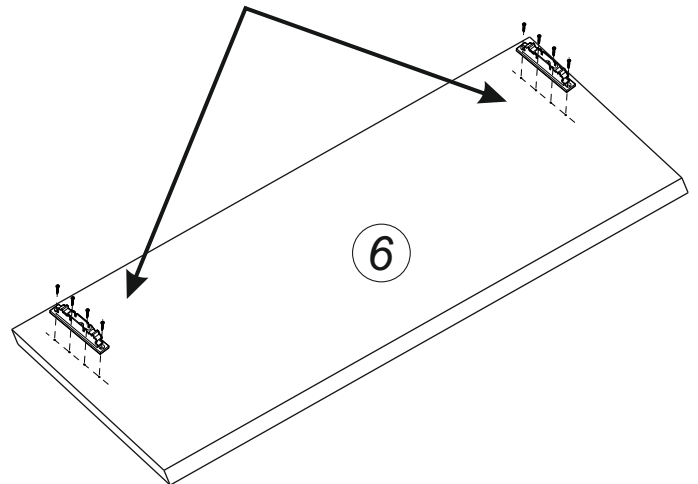
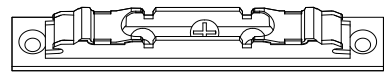

Pericolo di lesioni a causa del possibile scatto della leva verso l'alto !

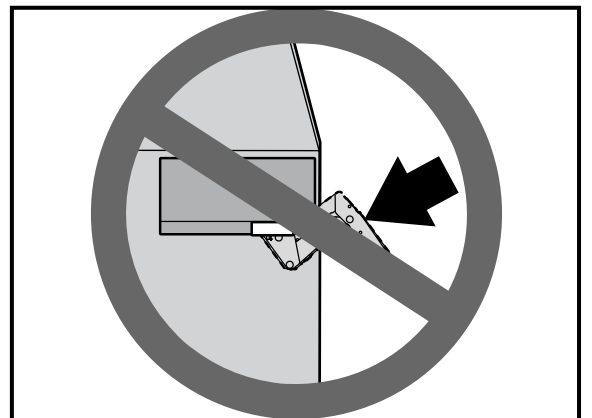

Non spingere la leva verso il basso dopo averla sollevata

SISTEMA HK TOP

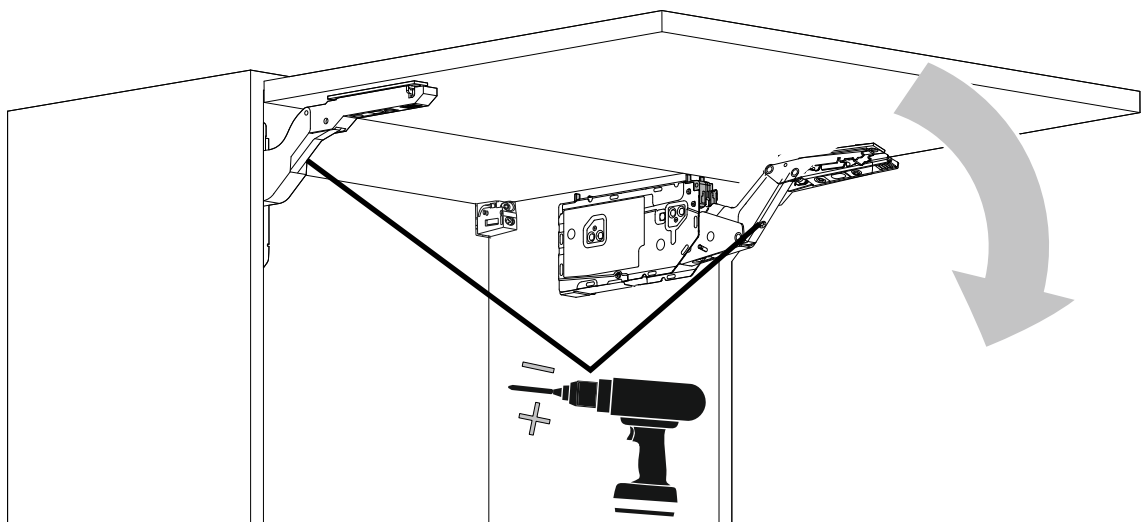
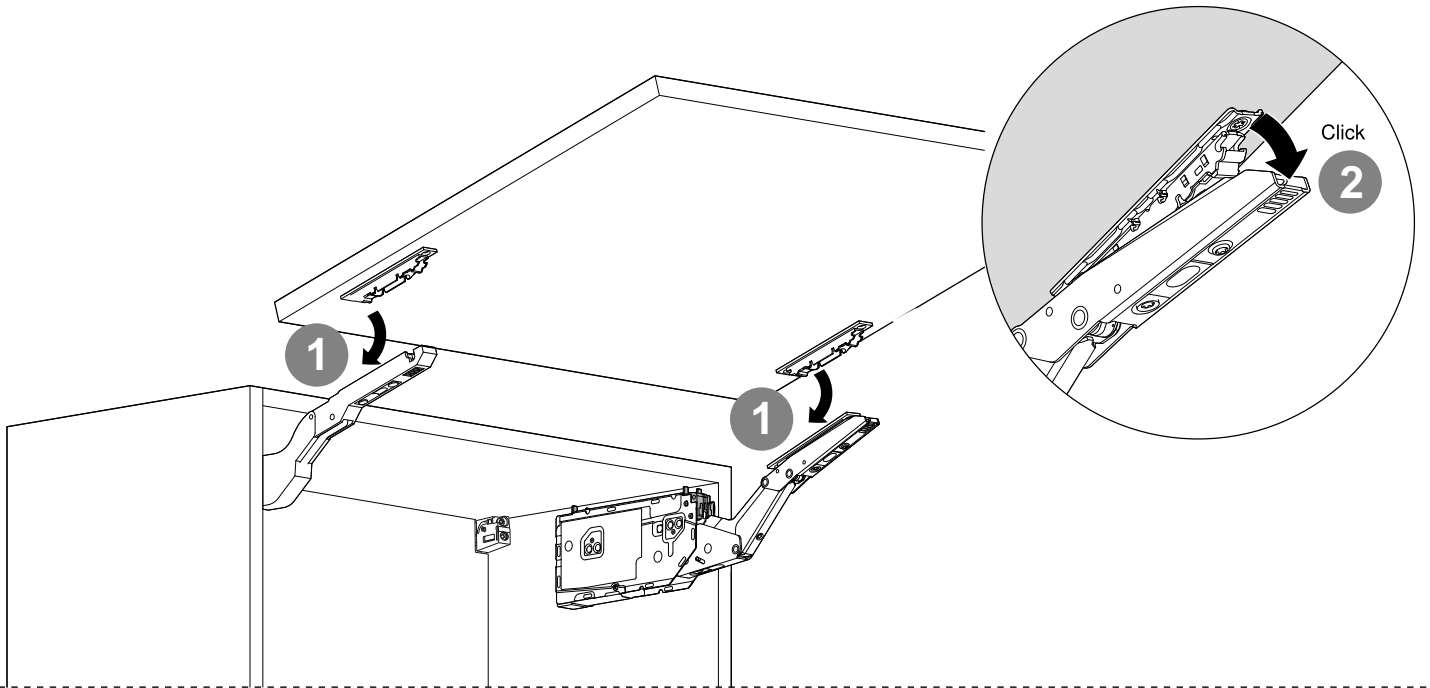
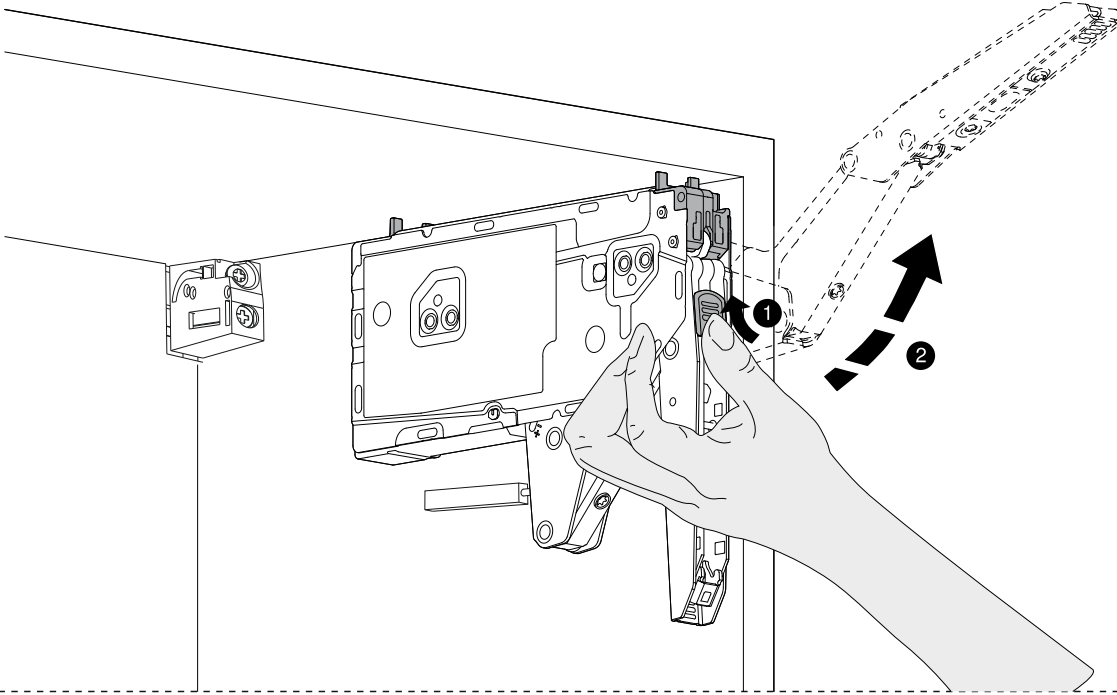

SISTEMA HK TOP

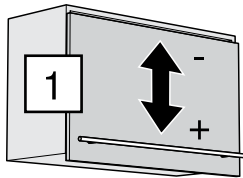
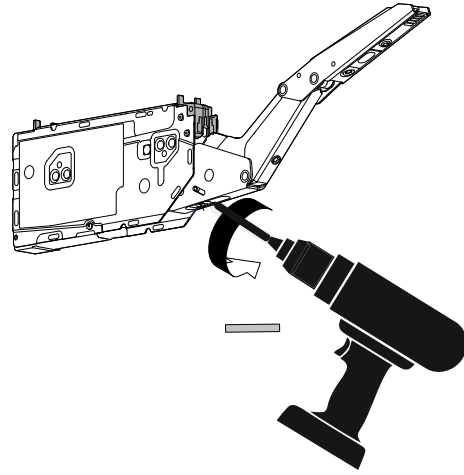
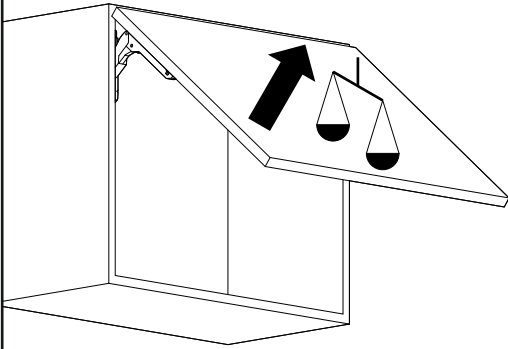
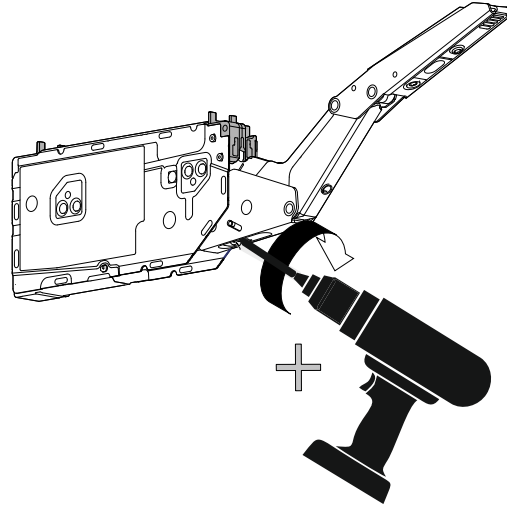
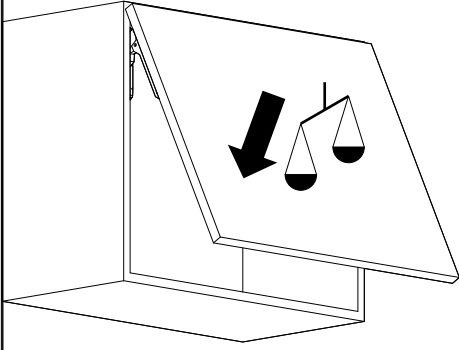

± 2

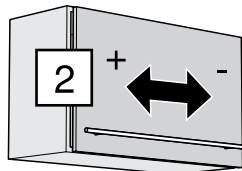

± 2

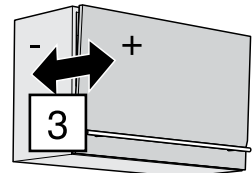

± 2

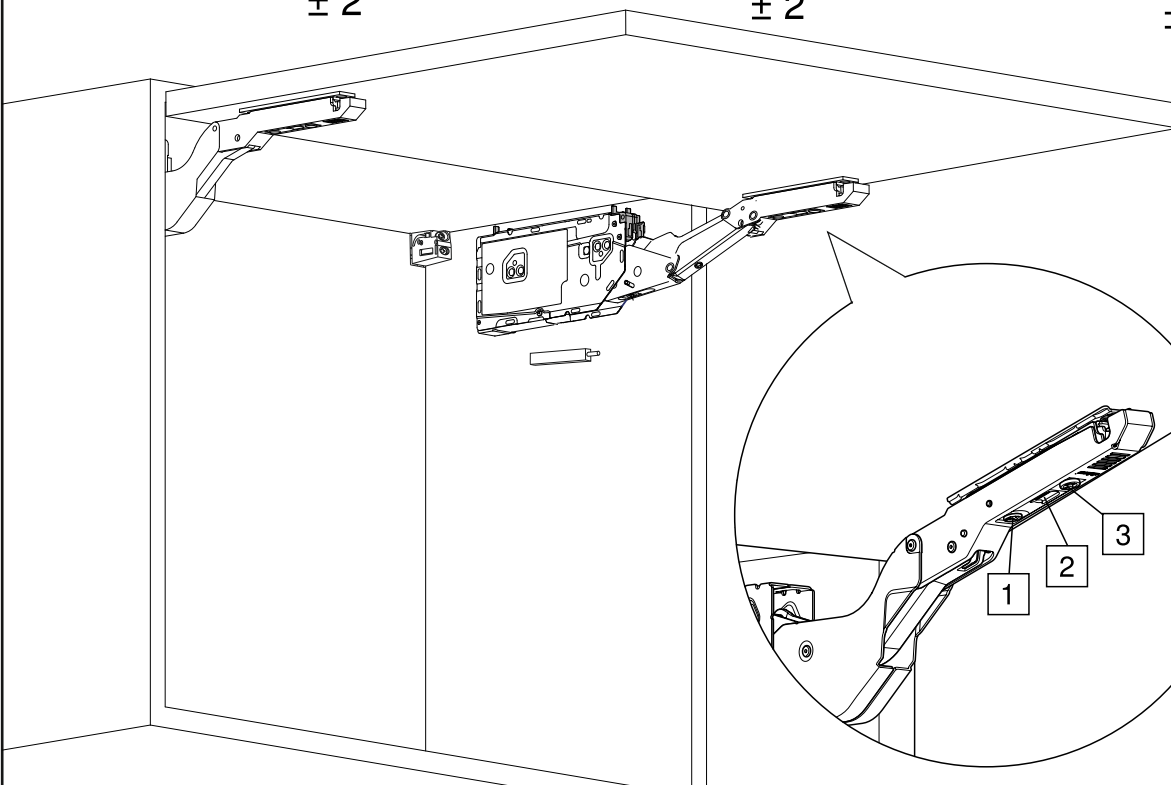

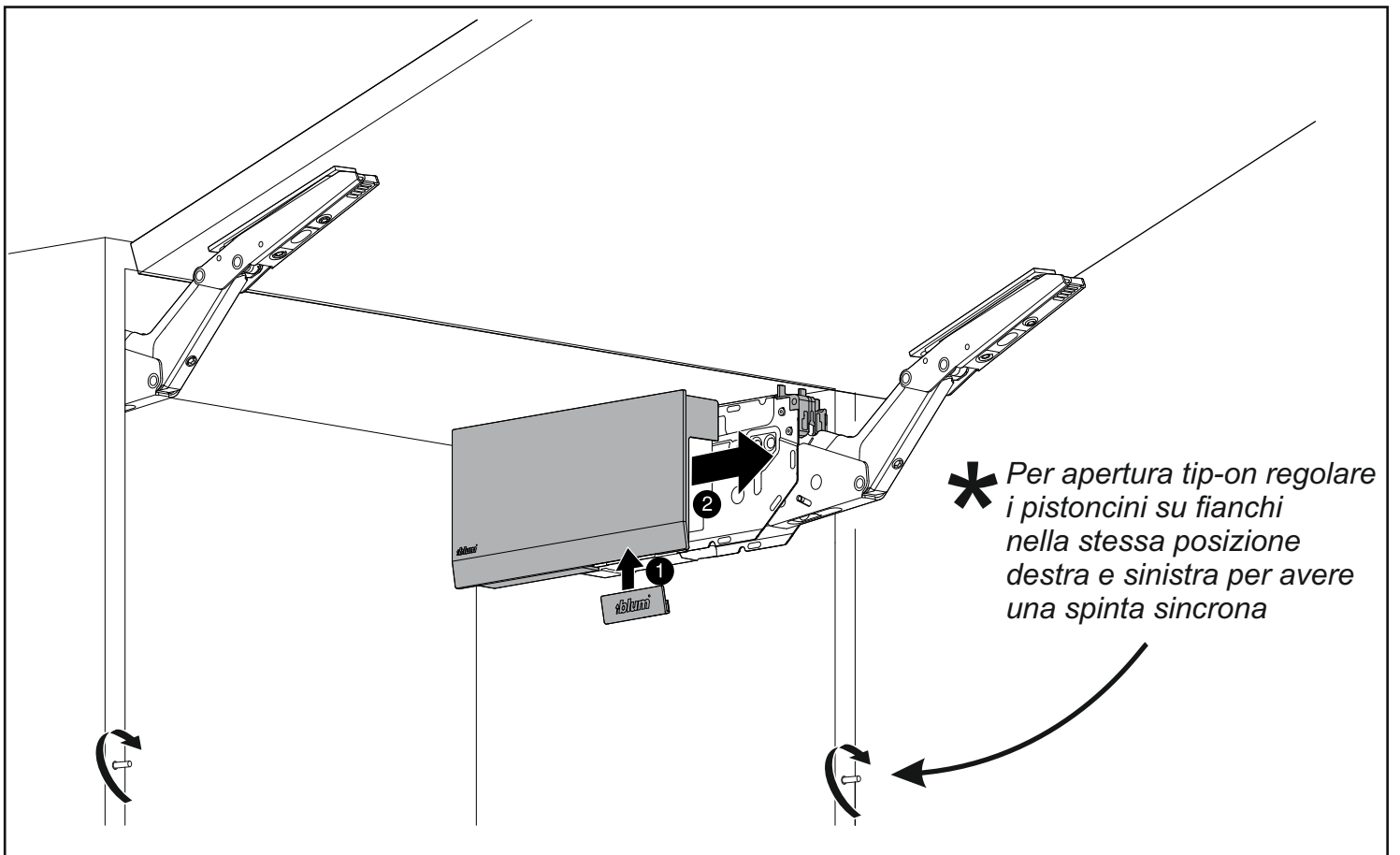

***** Per pensile con $L > 900\text{mm}$ inserire la barra di supporto sul retro dello scocca e la barra antiflessione per il ripiano prima di assemblare le ante

